

GE423 Laboratory Equipment Printing 3D parts

The GE department has a rapid prototyping machine you can use to make parts for the final projects. This service is provided at no cost to you

Using the SLA (*Stereo Lithography*)

- Location: Room 303A, right down the hall from the Mechatronics Lab
- Schedule: Hours are 12-6 Monday—Thursday and 12-5 on Friday.
- Details: The lab is fully staffed with helpful people and headed by a friendly lady named Jess who knows a lot about the system. Simply make a part in AutoDesk Inventor and either save it as an `.stl` file (stereo lithography file) or save it as a part and the helpful staff will show you what to do. The SLA lab will load the `.stl` file onto their *dimension sst 1200* printer, let you pick the color (I chose blue) and load the correct ABS plastic. The service is free for GE classes. Your file is put into the work queue and completed as time permits.



Mechatronics lab

SLA lab

Room 303A

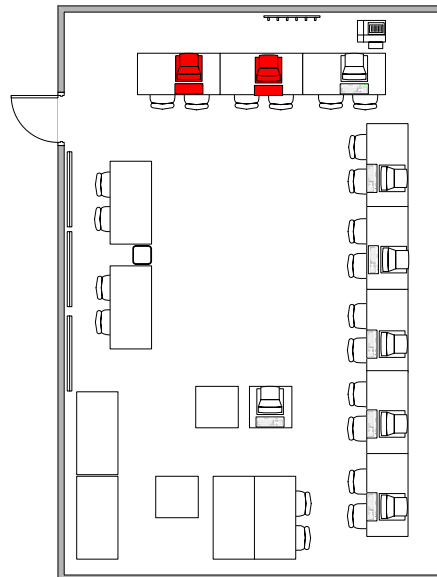
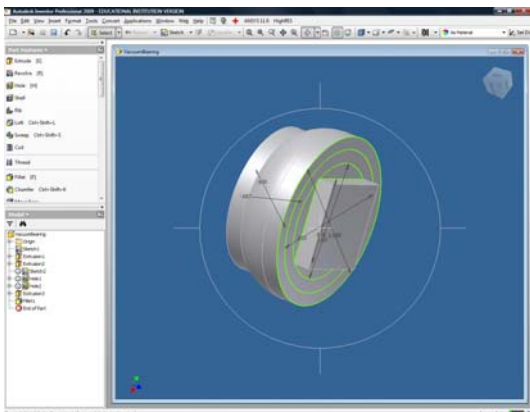

My part, drafted in AutoDesk Inventor. AutoDesk Inventor is installed on two machines (in red above) in the Mechatronics lab and is also available in the SLA lab.



The 3D printer



My part after printing – ready to be soaked in solution to remove the temporary support material



The part – in blue – now cleaned of the support material



The part (installed) is a bearing mount